

# Sudarshan Rangmanch

## Stage dimensions –

Width 25' X Depth 18' X Height- 10'

Backdrop –black

## Graphical Views-

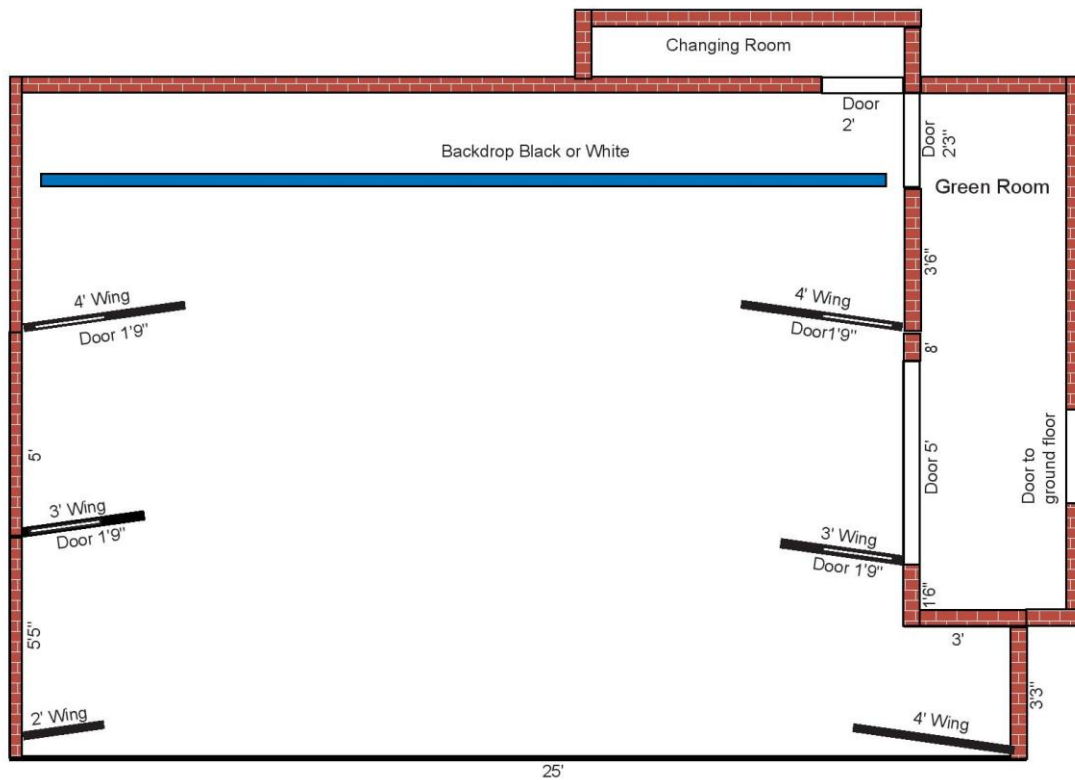

## Accessories-

Wooden Levels – 5 Nos. (L 5' X W 2' x H 6")

Wings –6 Nos. (H 9' X W 4')

Wooden Dados – 5 Nos. (1.5' x 1.5' x 1.5')

Wooden Tables- 2 Nos. (5' X 2.5')

Wooden stools – 2 Nos.

Stainless steel podium- 1 Nos.

## **Other Technical availabilities-**

### **Lights-**

Fresnel Spot (1000w) – 4 Nos.

Fresnel Spot (650w) – 15 Nos.

PAR can (1000w) – 6 Nos.

Pulsar board – 1 Nos.

### **Sound-**

Allen & Heath Wizard 16:2 16 channel mixer – 1 Nos.

Foot microphone – 3 Nos.

SM 58 microphone – 2 Nos.

SM 57 microphone – 2 Nos.

PG 48 microphone – 2 Nos.

PG 58 microphones – 2 Nos.

Superlux standard microphones- 12 Nos.

Regular large stand – 1 Nos.

Regular small stand – 5 Nos.

Quest powered monitor - 2 Nos.